



## Wharfside Apartments, BL8 1DE £1,100 PCM

A beautifully presented duplex apartment set over two floors within a peaceful converted mill development in Bury.

This spacious property features a bright and modern open-plan kitchen, dining and lounge area, complete with a Juliet balcony offering pleasant views. There are two well-proportioned bedrooms and a stylish three-piece bathroom suite with a shower over the bath.

Externally, the property benefits from a private decking area accessed via patio doors from one of the bedrooms — perfect for relaxing and entertaining during the summer months.

Additional benefits include electric heating, uPVC double glazing, and allocated parking for two vehicles.

An early viewing is highly recommended!



**Disclaimer:**

These particulars, whilst believed to be accurate are set out as a general guideline and do not constitute any part of an offer or contract. Intending Tenants should not rely on them as statements of representation of fact, but must satisfy themselves by inspection or otherwise as to their accuracy. Please note that we have not tested any apparatus, equipment, fixtures, fittings or services including gas central heating and so cannot verify they are in working order. Although we try to ensure accuracy, if measurements are used in this listing, they may be approximate. Therefore if intending Tenants need accurate measurements to order carpeting or to ensure existing furniture will fit, they should take such measurements themselves. Photographs are reproduced general information and it must not be inferred that any item is included for let with the property. Please contact 01706 823 131 for further details.

Viewing:

Viewing strictly by appointment through Lifestyle Sales and Lettings.

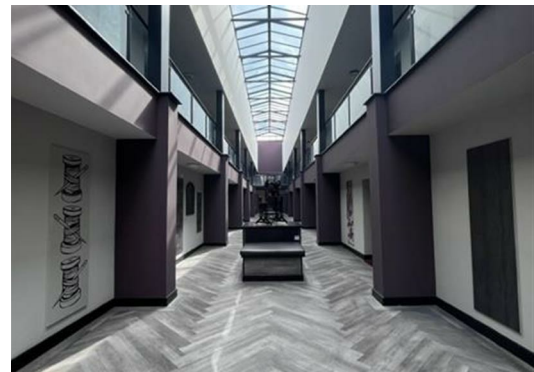
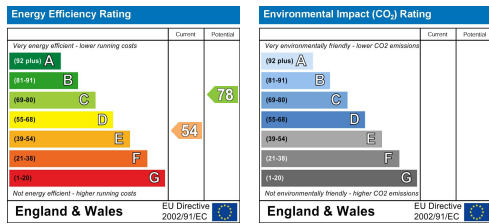

Head Office: 121 Whalley Road, Ramsbottom, Lancashire, BL0 0DG

Telephone: 01706823131 Email: enquiries@lifestylesalesandlettings.co.uk Website: www.lifestylesalesandlettings.co.uk